

Warnings!



Watch out for the scratches that may be caused by the cabinet, chassis or rails.

Be aware of electric shock when installing the servers into the cabinet in use.

- Do not block the vents on the server during installation.
- Remove the protective film from the chassis before installing servers into the rack.
- Leave a minimum clearance of 150 mm (5.9 in.) for the front and rear ends of the server to ensure proper ventilation.
- Always install blanks if the bays have not been loaded with any equipment to ensure proper air flow and avoid air turbulence in the server room.
- Servers can only be deployed in dedicated cabinets with vents or specialized liquid cooling cabinets to avoid server failure from overheating as they are high power appliances.
- In case of multiple-equipment deployment, always load from bottom to top and place the heaviest equipment in the bottom bay.
- Do not install equipment beyond the cabinet's load-bearing capacity, power supply capacity and heat dissipation capacity.
- For easy access of the front and rear ports and cable routing, leave a minimum clearance of 70 mm (2.8 in.) between the server front end and the cabinet front door, and a minimum clearance of 150 mm (5.9 in.) between the server rear end and the cabinet rear door.



For equipment _ 15 kg (33.07 lbs), use at least 2 people.



For equipment _ 30 kg (66.14 lbs), use at least 3 people.



For equipment _ 50 kg (110.23 lbs), use at least 4 people.

Please keep this document for future reference.

Rack Server
Mona 1U Series
Installation Guide

Rail 1

Identifying the Rail

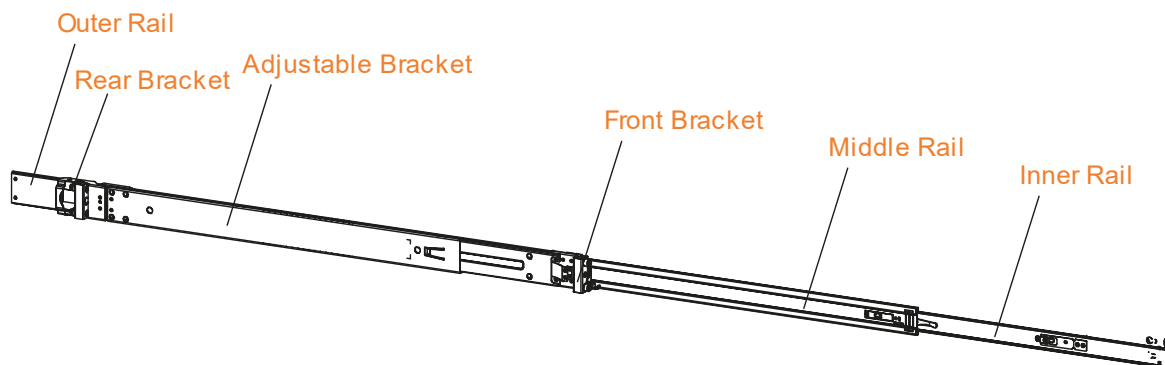

Installing the Rails and Server

- 1 Determine the mounting holes for the rear bracket. Align the mounting pins on the rear bracket with the mounting holes on the mounting flange. Rotate the locking latch as indicated by the arrow on the latch and push the rear end in as indicated by arrow ① until the mounting pins are engaged with the mounting holes. Then release the locking latch.

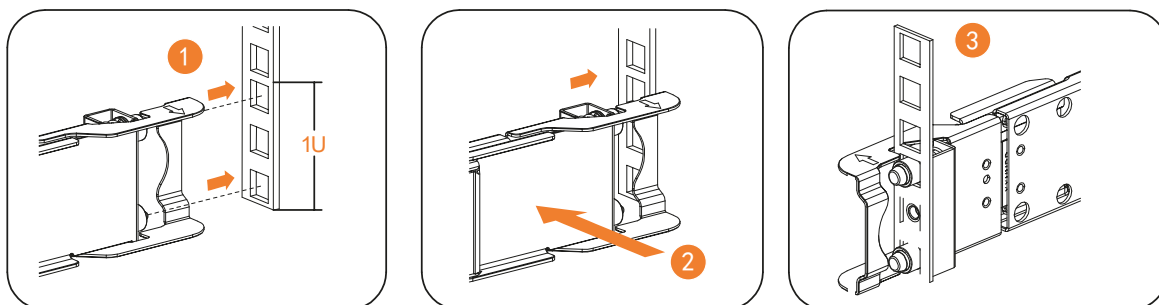

- 2 Follow step 1 to install the front bracket.

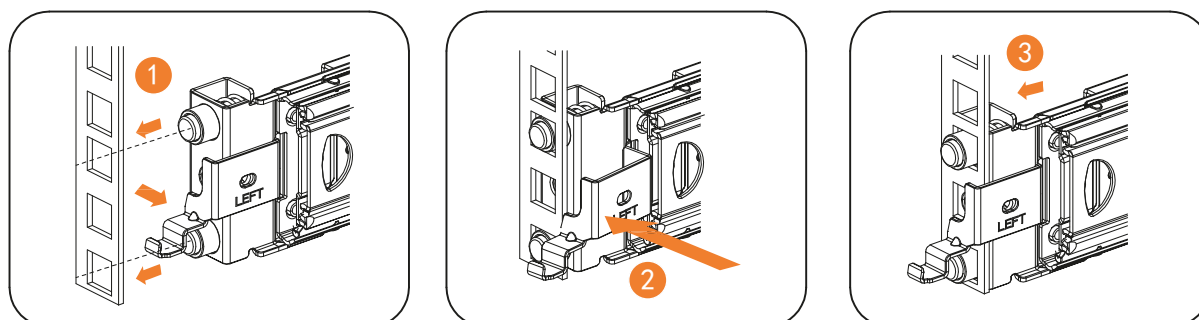

- 3 Repeat steps 1-2 to install the other rail.

NOTE: The rear and front brackets, and the two rails must be installed at the same height.

- 4 Extend the inner rail until it clicks into a locked position. Push up the release tab as indicated by ②, and then remove the inner rail from the middle rail. Repeat the same steps for the other inner rail.

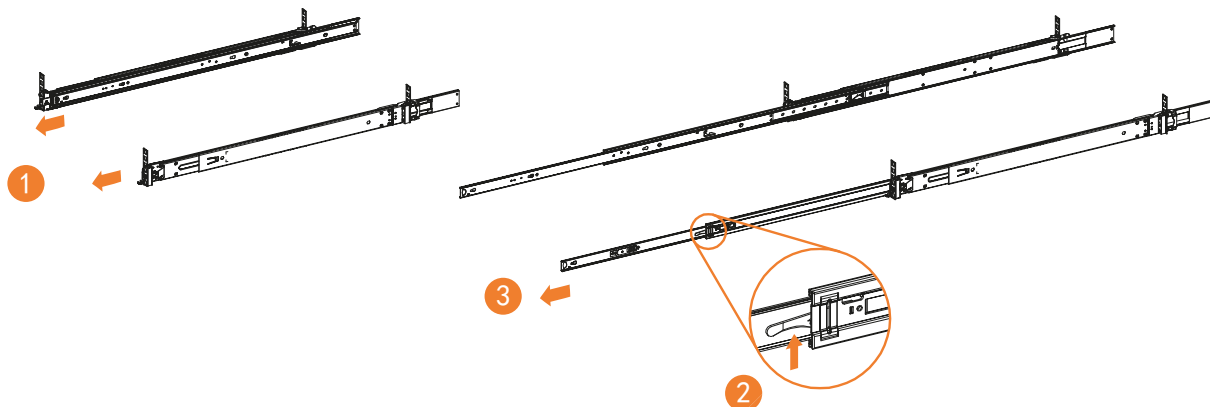

- 5 Align the keyholes of the inner rail with the stand-offs on the side of the server, attach the inner rail to the server, and then push the inner rail toward the rear of the server to secure it in place. Repeat the same steps to install the other inner rail. Fully extend the middle rails to the locked positions. Insert the inner rails to the middle rails.

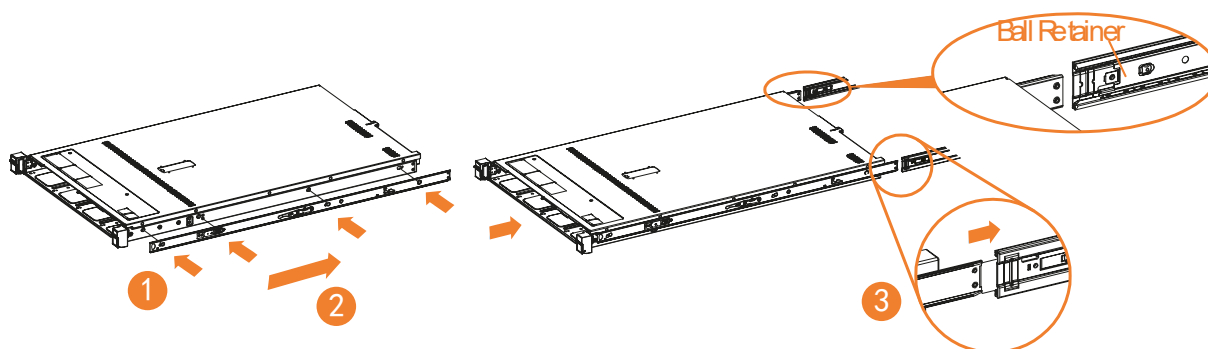

NOTE: The inner rail marked with L/R is the left/right inner rail and should be installed on the left/right side of the server with the mark facing inward, before inserting the inner rails to the middle rails, make sure the ball retainers are at the very front of middle rails; otherwise, manual adjustment is needed.

- 6 Lift up the release tabs on both inner rails simultaneously, and then gently push the server all the way into the rack. Open the ear latches and tighten the captive screws under the ear latches with a screwdriver.

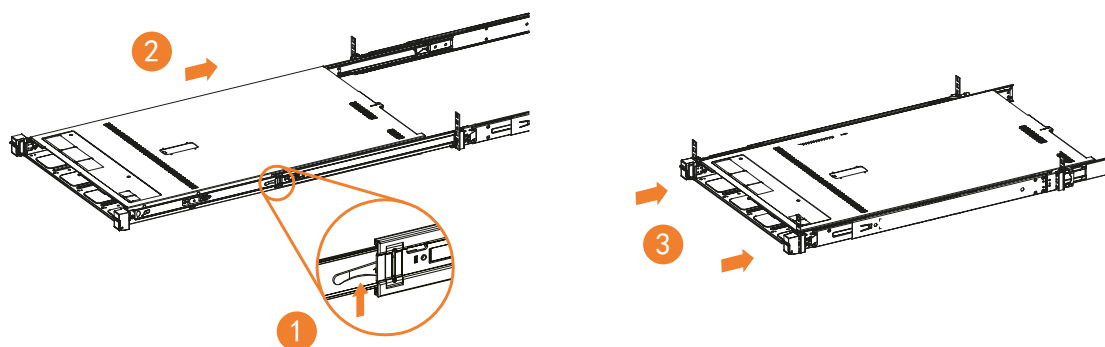

NOTE: Avoid pinching fingers and hands when installing.

Removing the Server and Rails

- 1 Open the ear latches, and then loosen the two captive screws under the ear latches. Gently slide the server out until it is in a locked position.

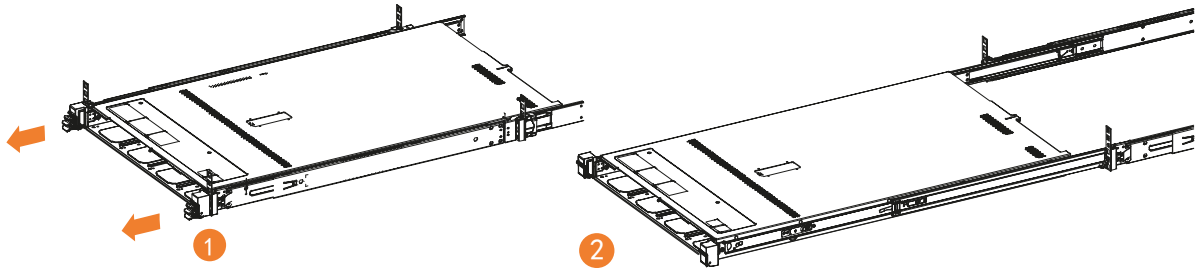

- 2 Push up the release tabs on both sides simultaneously, and then gently remove the server along with the inner rails from the rack.

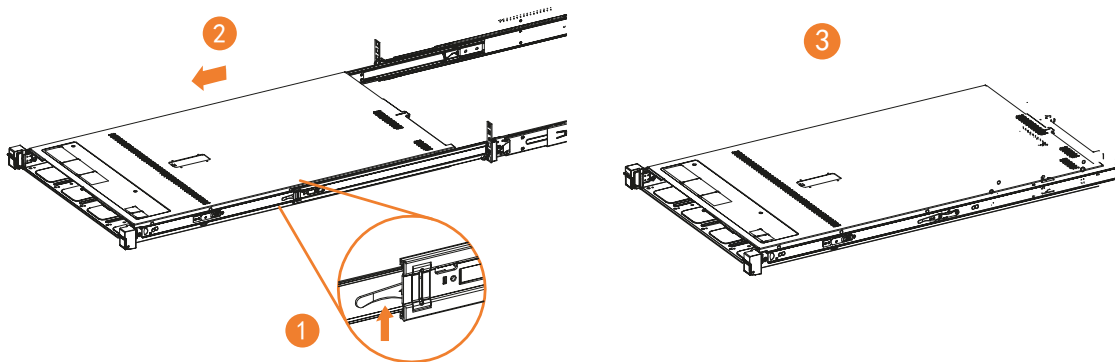

- 3 Pull the locking plate to disengage the inner rail from the server. Push the inner rail toward the front of the server to remove it. Repeat the same steps to remove the other inner rail.

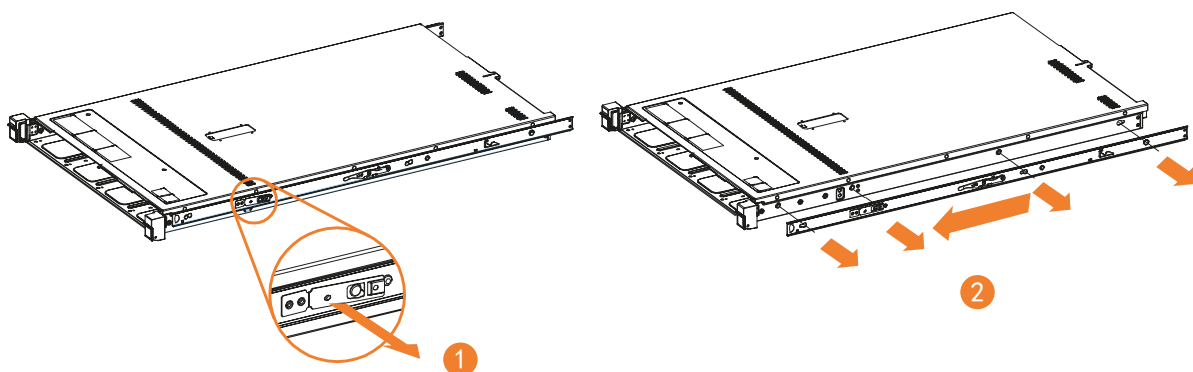

NOTE: Do not over-pull the locking plate to prevent permanent deformation.

4 Remove the rails in the reverse order of the installation.

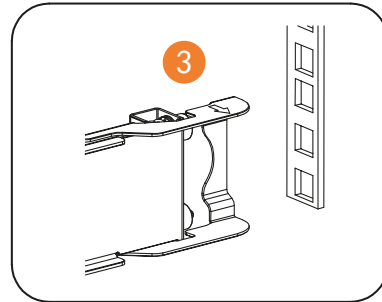
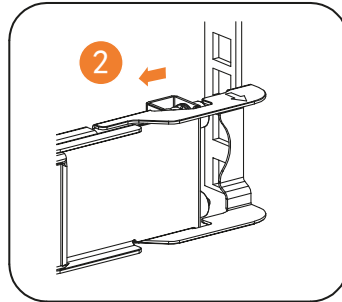
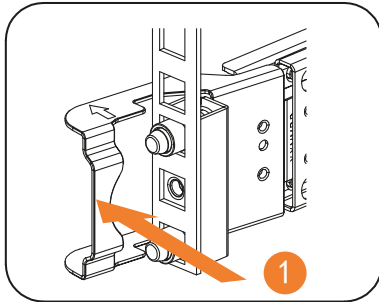
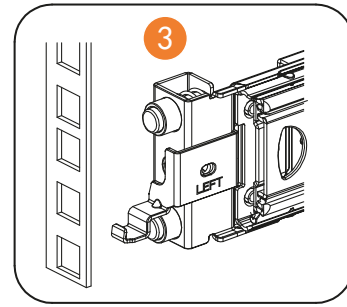
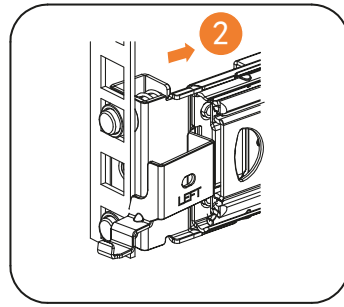
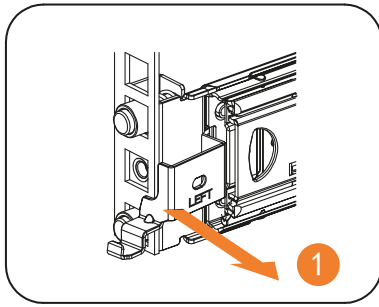

Rail 2

Identifying the Rail

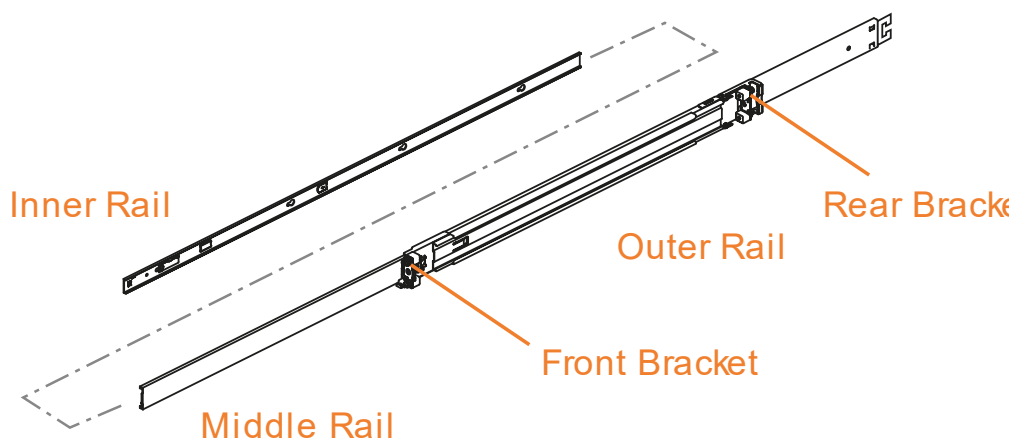

Installing the Inner Rails to the Server

- 1 Extend the inner rail until it clicks into a locked position. Pull the white tab forward to slide and remove the inner rail from the middle rail. Repeat the same steps for the other inner rail.

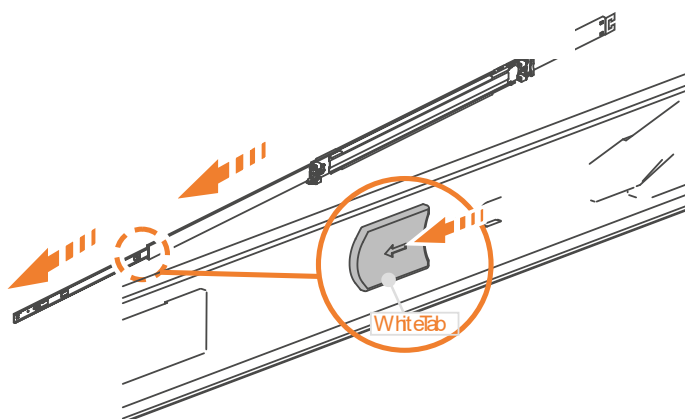

NOTE: When removing the inner rail, the middle rail extends with the inner rail. Push up the release tab (a) to slide the middle rail back.

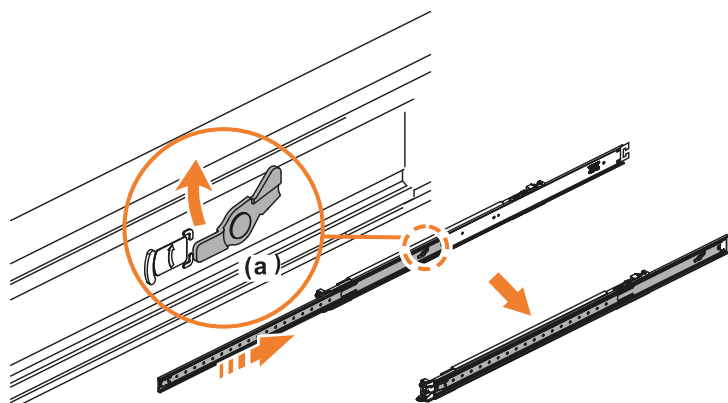

- 2 Align the keyholes of the inner rail with the standoffs on the side of the server, attach the inner rail to the server, and then push the inner rail toward the rear of the server to secure it in place. Repeat the same steps to install the other inner rail.

NOTE: Make sure the left and right inner rails (with "L" and "R" letters) are correctly installed to the server.

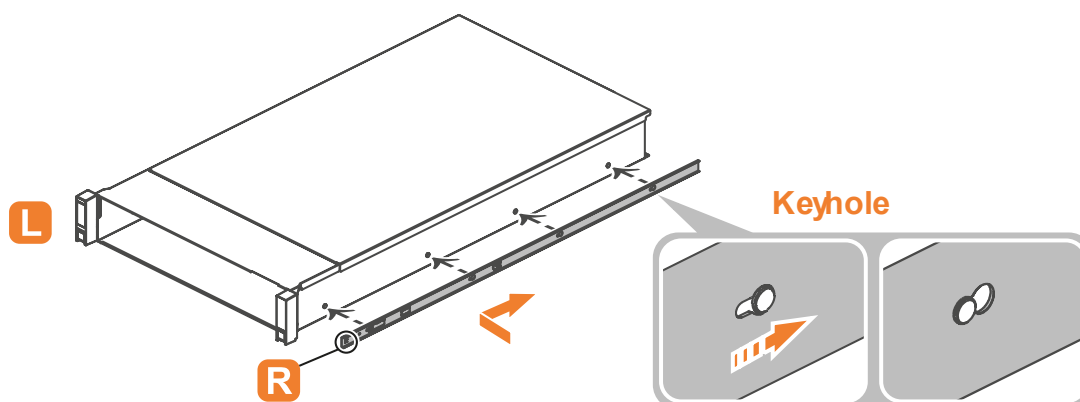

Installing the Rails to the Rack

1. Determine the mounting holes for the rear bracket.
2. Align the mounting pins on the rear bracket with the mounting holes on the mounting flange. Rotate the locking latch as indicated by the arrow and push the rear end in until the mounting pins are engaged with the mounting holes. Then release the locking latch.
3. Follow step 1 and step 2 to install the front bracket.
4. Repeat steps 1-3 to install the other rail to the rack. Make sure the left and right rails (with "L" and "R" letters) are correctly installed to the rack.

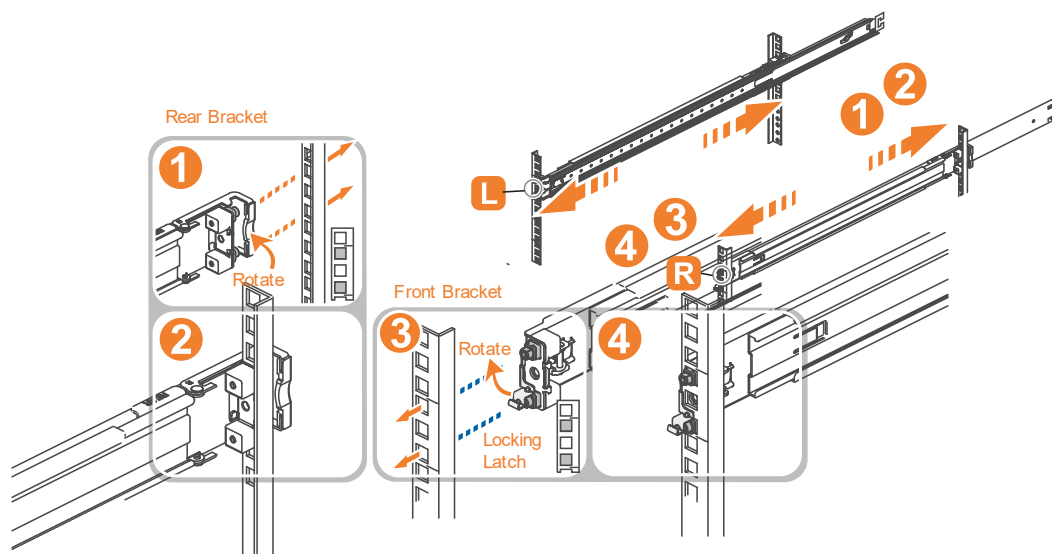

NOTE: Make sure that the ball retainers fully appear.

Installing the Server to the Rack

1. Fully extend the middle rails to the locked positions. Lift up the server. Align the inner rails with the middle rails and gently push the server until it is locked.

NOTE: Make sure that the ball retainers fully appear.

2. Pull the blue tabs forward or backward, and then carefully push the server all the way into the rack.
3. Open the ear latches, and then tighten the two captive screws under the ear latches.

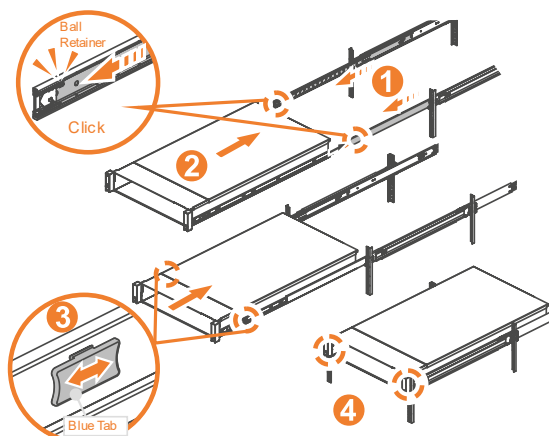

NOTE: Avoid pinching fingers and hands when installing.

Removing the Server from the Rack

1. Open the ear latches, and then loosen the two captive screws under the ear latches. Gently slide the server out until it is in a locked position.
2. Pull the two white tabs forward simultaneously. Slide and remove the server along with the inner rails from the rack.
3. Push up the release tabs (a) to slide the middle rails back.

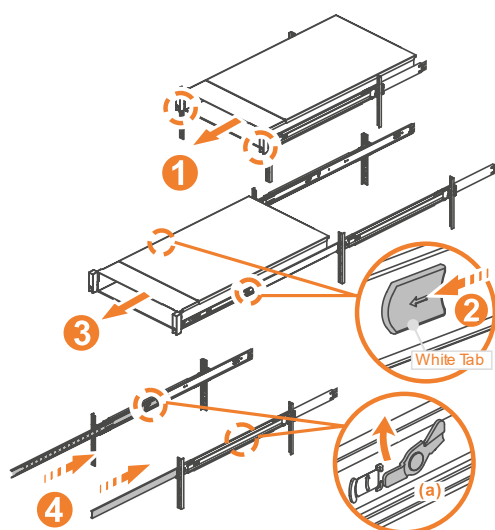

Removing the Rails from the Rack

Remove the rails in the reverse order of their installation.

Removing the Inner Rails from the Server

Pull the locking plate to disengage the inner rail from the server. Push the inner rail toward the front of the server to remove it. Repeat the same steps to remove the other inner rail.

NOTE: Avoid applying excessive force to the locking plates.

